

Ø 3.00 THRU x 4 places

Ø 8.00 THRU x 2 places

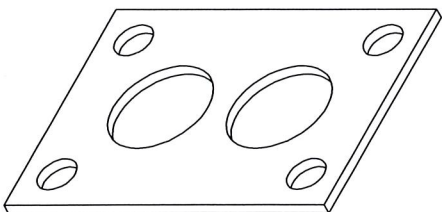
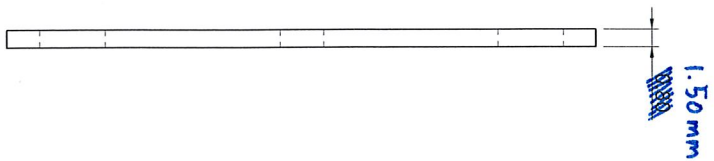

- NOTES:
1. REMOVE ALL BURRS AND SHARP EDGES.
 2. PARTS TO BE SUPPLIED CLEANED AND FREE FROM CUTTING FLUIDS, SWARF OR ANY CHEMICAL RESIDUES LEFT DURING PROCESSING.
 3. TAPPED HOLES TO BE DE-BURRED BY COUNTERSINKING 90 DEGREES TO ROOT DIAMETER OF THREAD.
 4. ALL NON DIMENSIONED FEATURES SHALL BE WITHIN 0.25 mm OF THE CAD MODEL.
 5. FINISH: NATURAL.

REV	AMENDMENT	BY	CHK	DATE	TITLE
A	First Release				Cryostat Double Round Hole Plate
					Description: XAS Sample Holders
					DWG NO: 1201-0045-01A
					MATERIAL: PMMA/Acrylic
					Solid Edge
					DO NOT SCALE
					SHEET 1 OF 1
					A4

THE DRAWING IS THE PROPERTY OF
**SYNCHROTRON
 LIGHT SOURCE
 AUSTRALIA**



UNLESS OTHERWISE SPECIFIED AS 1100 1987
 DIMENSIONS ARE IN MILLIMETERS ISO 129:1985

GENERAL TOLERANCE
 X = +0.5 X = +0.25 XX = ±0.10 ANGLE ±0.5°

APPROVED

contact: us@synchrotron.org.au

NAME	DATE
DRAWN: Hima	20/09/16
CHECKED:	20/09/16

©2016 Synchrotron Light Source Australia. All Rights Reserved. This drawing is the property of Synchrotron Light Source Australia. Reference: PLS.V3